

allegro red



TIFFIN MOTORHOMES
WHEREVER YOU GO, WE GO.



COCKPIT CONSOLE



DINETTE



KITCHEN



YOU WON'T JUST SEE THE DIFFERENCE. YOU'LL FEEL IT AND HEAR IT, TOO. The 2013 Allegro RED from Tiffin Motorhomes. All the cozy comforts of our popular Allegro model equipped with the mighty muscle of a rear engine diesel (RED). The results easily speak for themselves. More torque. More horsepower. More legroom. This year, Tiffin has enhanced the driving experience for better handling and more automotive drivability. While redesigned fixtures create a more efficient dash, the new chrome head side-view mirrors with built-in cameras improve driving safety. With a towing capacity of 5,000 pounds, the Allegro RED can easily pull a car or boat. Storage is plentiful, too. Space-saving cabinetry in the coach and up to 160 cubic feet of room underneath allow you to bring everything you need—and more.



TV/CHEST OF DRAWERS



MASTER BEDROOM/CITY LIGHTS FABRIC SUITE



BATHROOM VANITY



COVER

2013 ALLEGRO RED WITH SILVER SAND EXTERIOR

LIVING AREA

38 QBA FLOOR PLAN/CITY LIGHTS FABRIC SUITE WITH ENGLISH CHESTNUT CABINETS

INTERIOR DÉCOR

Make yourself at home in your Allegro RED with an interior that reflects your taste and style. For 2013, you'll choose from three exclusive fabric designs—Autumn, City Lights, or Raven. Each interior scheme comes with matching window valances, solid surface countertops, plus solid wood cabinet doors and fascias. Simply add your decorative touches to create the perfect home away from home.

CABINETS



MEDIUM ALDERWOOD



ENGLISH CHESTNUT

COUNTERTOP & FLOORING



COUNTERTOP



CARPET



TILE

AUTUMN FABRIC SUITE

LIVING AREA



DINETTE



ACCENT

SOFA & DRIVER/PASSENGER SEAT

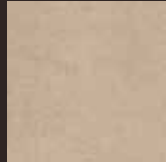

STANDARD CLOTH



OPTIONAL LEATHER

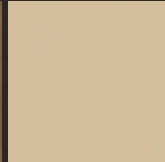

OPTIONAL LEATHER

BEDROOM



MAIN

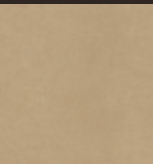

ACCENT

CITY LIGHTS FABRIC SUITE

LIVING AREA



DINETTE



ACCENT

SOFA & DRIVER/PASSENGER SEAT

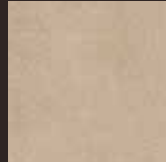

STANDARD CLOTH

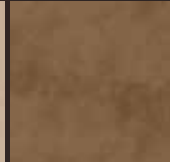

OPTIONAL LEATHER



OPTIONAL LEATHER

BEDROOM



MAIN



ACCENT

RAVEN FABRIC SUITE

LIVING AREA



DINETTE

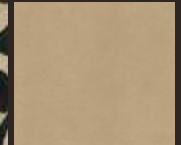

ACCENT

SOFA & DRIVER/PASSENGER SEAT

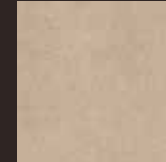

STANDARD CLOTH



OPTIONAL LEATHER

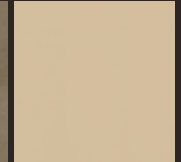

OPTIONAL LEATHER

BEDROOM



MAIN



ACCENT

Allegro RED cabinet doors & fascias are made of solid wood, & all cabinet finishes are available in combination with any fabric suite. All options may not be available in every model. Because of progressive improvements, specifications, standard & optional equipment are subject to change without notice or obligation. For a complete & up-to-date list of available options & specifications, visit tiffinmotorhomes.com

FLOOR PLANS

34 QFA

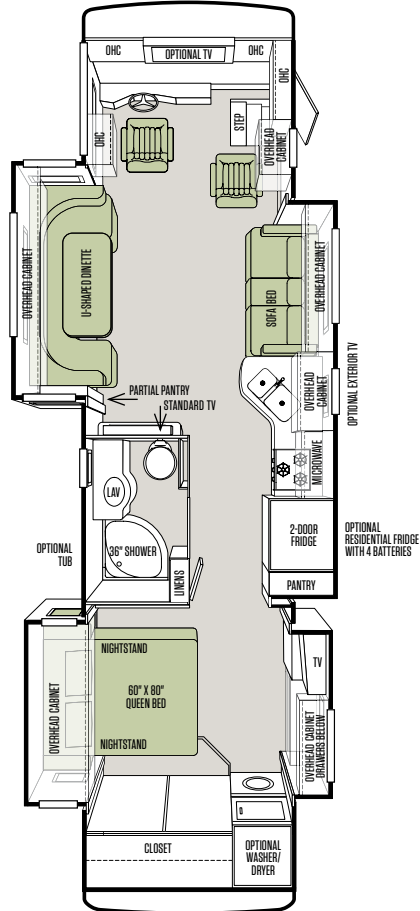

36 QSA

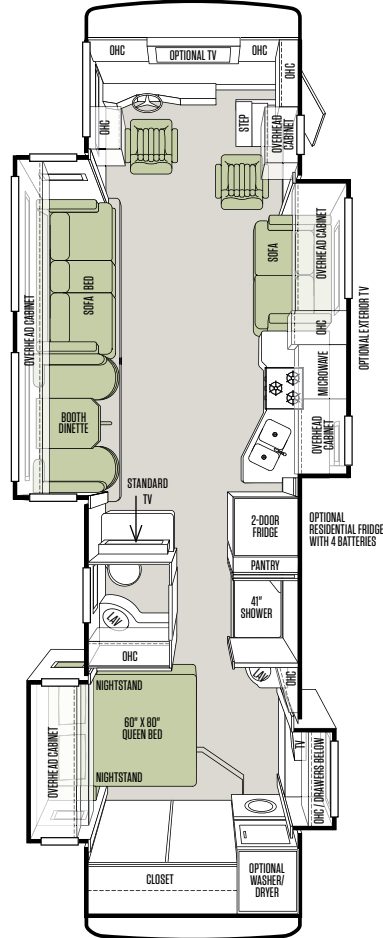

38 QBA

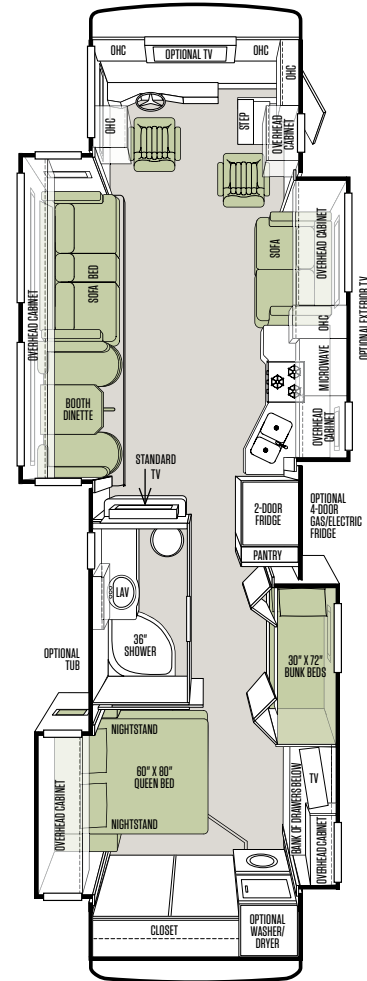

38 QRA

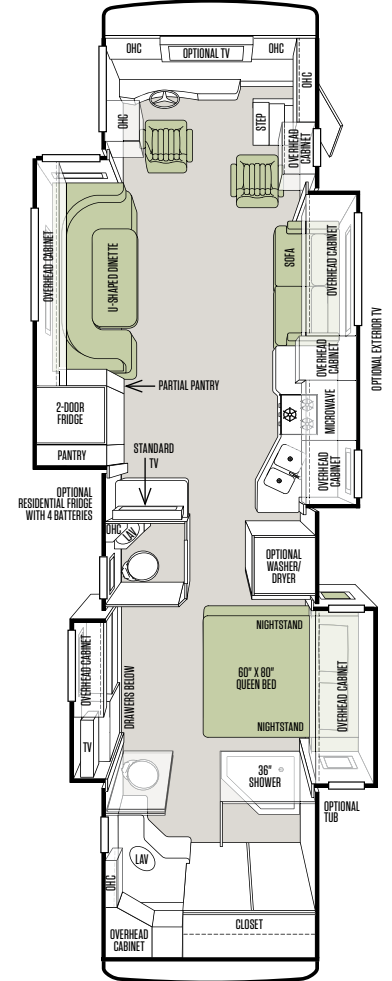

AVAILABLE OPTIONS:

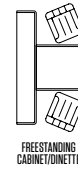
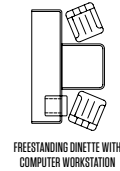
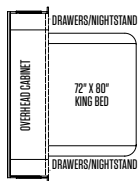



OPTIONAL STACKED WASHER/DRYER



LIVING AREA/COCKPIT



BUNK BEDS WITH DVD MONITORS (38 QBA)

SPECIFICATIONS

AUTOMOTIVE

STANDARD ON ALL MODELS:

- Raised Rail Chassis Frame
- Air Ride Suspension
- Full Air Brakes
- Exhaust Brake

CHASSIS OPTIONS

FREIGHTLINER® REAR ENGINE DIESEL CHASSIS:

	34 QFA	36 QSA	38 QBA	38 QRA
Cummins ISB 6.7-liter Electronic Diesel, Turbocharged, Aftercooled Engine	S	S	S	S
Peak HP – 340 HP @ 2,600 RPM	S	S	S	S
Peak Torque (Lb. – Ft. Max Net) 660 @ 1,600 RPM	S	S	S	S
Allison 2500 MH 6-speed Automatic with Lock-up	S	S	S	S
GAWR – Front	12,000 Lb.	12,000 Lb.	12,000 Lb.	12,000 Lb.
GAWR – Rear	17,500 Lb.	17,500 Lb.	17,500 Lb.	17,500 Lb.
GVWR	29,500 Lb.	29,500 Lb.	29,500 Lb.	29,500 Lb.
GCWR	33,000 Lb.	33,000 Lb.	33,000 Lb.	33,000 Lb.
Wheel Base	208"	228"	252"	252"
Tire Size	275/80R22.5	275/80R22.5	275/80R22.5	275/80R22.5
Fuel Tank (Gallons) – Dual Fuel Fill	100	100	100	100
DEF Tank* (Gallons)	13	13	13	13
Alternator Amps	160	160	160	160
Trailer Hitch Capacity	5,000 Lb.	5,000 Lb.	5,000 Lb.	5,000 Lb.

WEIGHTS & MEASURES

OVERALL:	34 QFA	36 QSA	38 QBA	38 QRA
Overall Length (Approximate)	34' 10"	36' 9"	38' 9"	38' 9"
Overall Height with Roof Air (Maximum)	12' 10"	12' 10"	12' 10"	12' 10"
Interior Height	84"	84"	84"	84"
Overall Width	101"	101"	101"	101"
Interior Width	96"	96"	96"	96"
Fresh Water (Gallons)	90	90	90	90
Black Water (Gallons)	50	50	50	50
Grey Water (Gallons)	70	70	70	70
LPG Tank (Gallons; can only be filled to 80% capacity)	24	24	24	24
Basement Storage (Cubic Feet – Approximate)	87	150	160	160
Minimum Garage Height	13'	13'	13'	13'

*Diesel Exhaust Fluid (DEF) is the active component used in Selective Catalytic Reduction (SCR) engines to reduce nitrogen oxide emissions by 90% to meet EPA standards.



SPECIFICATIONS

GENERAL EXTERIOR

STANDARD ON ALL MODELS:

- Fiberglass Front & Rear Caps
- Tinted One-piece Windshield
- 6.0 kw Onan® Generator
- Horizontal Mounted Wipers
- Heated Power Mirrors
- Exterior Patio Light
- Power Patio Awning with Aluminum Weather Shield
- Awning(s) over Slide-outs
- Chrome Wheel Liners
- Quiet AC Roof-ducted System
- Two High Profile Roof ACs
- Double Electric Step
- 1/4" Thick Single Pane Windows
- Convenient Access Doors with Gas Shocks
- Single Handle Lockable Storage Door Latches
- Heated Water & Holding Tank Compartment
- Four 6 V Auxiliary Batteries
- Park Telephone Ready
- Digital TV Antenna
- Cable TV Ready
- 50 Amp Service
- Black Holding Tank Flush System
- Exterior Rinse Hose/Shower
- Gravity Water Fill
- Color Back-up Monitor
- 110 V Exterior Receptacle
- Undercoating
- Roof Ladder
- External Tripod Satellite Hook-up
- Exterior Storage Compartment Lights
- Chrome Mirror Heads with Integrated Turn Signal Cameras
- BASF Full-body Paint
- Hydraulic Automatic Leveling Jacks
- Front Cap Protective Film

AVAILABLE OPTIONS:	34 QFA	36 QSA	38 QBA	38 QRA
8.0 kw Onan® Generator	<input type="radio"/>	<input type="radio"/>	<input type="radio"/>	<input type="radio"/>
Automatic Satellite Dish*	<input type="radio"/>	<input type="radio"/>	<input type="radio"/>	<input type="radio"/>
Automatic Entry Door Awning	<input type="radio"/>	<input type="radio"/>	<input type="radio"/>	<input type="radio"/>
Air Horns	<input type="radio"/>	<input type="radio"/>	<input type="radio"/>	<input type="radio"/>
Two High Profile Roof ACs with Heat Pumps (Requires 8.0 kw Generator/Replaces Both Standard ACs)	<input type="radio"/>	<input type="radio"/>	<input type="radio"/>	<input type="radio"/>
Exterior TV	<input type="radio"/>	<input type="radio"/>	<input type="radio"/>	<input type="radio"/>

GENERAL INTERIOR

STANDARD ON ALL MODELS:

- High Gloss Raised Panel Hardwood Cabinet Doors
- Solid Wood Cabinet Fascias
- Soft Touch Vinyl Ceiling
- Midsection TV in Entertainment Center
- Wall-to-wall Vinyl Tile Flooring Throughout Coach
- Ball Bearing Drawer Slides
- Scotchgard® Treated Fabrics
- Solar/Privacy RollEase® Shades
- Power Roof Vents
- Tank Level Monitor System
- Smoke Detector
- 10-gallon DSI Gas/Electric Water Heater
- Power Step Well Cover
- 2000 Watt Sine Wave Inverter
- Carbon Monoxide Detector
- LPG Leak Detector

AVAILABLE OPTIONS:	34 QFA	36 QSA	38 QBA	38 QRA
Medium Alderwood Solid Cabinet Doors & Drawer Fronts	<input type="radio"/>	<input type="radio"/>	<input type="radio"/>	<input type="radio"/>
English Chestnut Solid Cabinet Doors & Drawer Fronts	<input type="radio"/>	<input type="radio"/>	<input type="radio"/>	<input type="radio"/>
Combo Washer/Dryer	<input type="radio"/>	<input type="radio"/>	<input type="radio"/>	<input type="radio"/>
Stacked Washer/Dryer	<input type="radio"/>	<input type="radio"/>	<input type="radio"/>	<input type="radio"/>
Central Vacuum Cleaner	<input type="radio"/>	<input type="radio"/>	<input type="radio"/>	<input type="radio"/>

COCKPIT

STANDARD ON ALL MODELS:

- Tilt Steering Wheel
- Dual Dash Fans
- Wood Drawers in Dash
- Lighted Instrument Panel
- CD Player & AM/FM Stereo
- 12 V Dash Receptacle
- Power Solar/Privacy Windshield Shades
- 12 V Disconnect Switch
- Non-power Cloth Driver & Passenger Seats
- Manual Solar/Privacy Shades on Side Windows
- Fire Extinguisher
- Adjustable Seatbelt Brackets

AVAILABLE OPTIONS:	34 QFA	36 QSA	38 QBA	38 QRA
Power Cloth Driver & Passenger Seats	<input type="radio"/>	<input type="radio"/>	<input type="radio"/>	<input type="radio"/>
Power Halo Leather Driver & Passenger Seats	<input type="radio"/>	<input type="radio"/>	<input type="radio"/>	<input type="radio"/>
Satellite-ready Radio (Requires Subscription)	<input type="radio"/>	<input type="radio"/>	<input type="radio"/>	<input type="radio"/>
In-dash Stereo/Navigational System	<input type="radio"/>	<input type="radio"/>	<input type="radio"/>	<input type="radio"/>
Overhead TV	<input type="radio"/>	<input type="radio"/>	<input type="radio"/>	<input type="radio"/>

*High-definition programming is not available on a domed satellite antenna unless you subscribe to DISH Network®.



SPECIFICATIONS

KITCHEN

STANDARD ON ALL MODELS:				
<div><div>• Double Bowl Kitchen Sink with Single Lever Bronze Faucet</div><div>• Solid Surface Countertops</div><div>• Stacked Drawers</div><div>• Solid Surface Backsplashes</div><div>• 3-burner Recessed Cooktop with Gas Oven</div><div>• Solid Surface Cooktop Cover</div><div>• Microwave with Exterior Venting</div><div>• Large 2-door Refrigerator</div></div>				
AVAILABLE OPTIONS:	34 QFA	36 QSA	38 QBA	38 QRA
Convection Microwave	O	O	O	O
Cooktop & Convection Microwave (No Gas Oven)	O	O	O	O
2-door Gas/Electric Refrigerator with Icemaker	O	O	O	O
4-door Gas/Electric Refrigerator with Icemaker	O	O	O	O
Solid Wood Refrigerator Panels	O	O	O	O
Residential Refrigerator with 4 Batteries	O	O	NA	O

BATH

STANDARD ON ALL MODELS:				
<div><div>• Medicine Cabinet</div><div>• Skylight in Shower with Sliding Cover</div><div>• Bronze Vanity Faucet</div><div>• Molded Fiberglass One-piece Shower</div><div>• Solid Surface Vanity Top</div><div>• Fantastic® Fan</div></div>				
AVAILABLE OPTIONS:	34 QFA	36 QSA	38 QBA	38 QRA
Tub (in Place of Shower)	O	NA	O	O

BEDROOM

STANDARD ON ALL MODELS:				
<div><div>• Wardrobe with Automatic Light</div><div>• Bed Comforter with Throw Pillows</div><div>• TV</div><div>• Vinyl Tile Flooring</div><div>• Inner Spring Queen Mattress (60" x 80")</div><div>• Solar/Privacy RollEase® Shades</div></div>				
AVAILABLE OPTIONS:	34 QFA	36 QSA	38 QBA	38 QRA
King Bed Mattress (72" x 80")	O	NA	NA	O
Bunk Beds (32" x 72") with Bunk Ladder/Convertible Wardrobe	NA	NA	S	NA
DVD Monitors in Bunk Beds	NA	NA	O	NA

LIVING AREA/DINETTE

AVAILABLE OPTIONS:	34 QFA	36 QSA	38 QBA	38 QRA
Contemporary Booth Dinette with Large Pullout Storage Drawers	NA	S	S	NA
Cloth DE Sofa/Sleeper on Passenger Side	NA	S	S	NA
Halo Leather DE Sofa/Sleeper on Passenger Side	NA	O	O	NA
Cloth Air Coil Hide-A-Bed Sofa/Sleeper on Passenger Side	S	NA	NA	S
Halo Leather Air Coil Hide-A-Bed Sofa/Sleeper on Passenger Side	O	NA	NA	O
Cloth Air Coil Hide-A-Bed Sofa/Sleeper on Driver Side	NA	O	O	NA
Halo Leather Air Coil Hide-A-Bed Sofa/Sleeper on Driver Side	NA	O	O	NA
Cloth DE Sofa/Sleeper on Driver Side	NA	S	S	NA
Halo Leather DE Sofa/Sleeper on Driver Side	NA	O	O	NA
Cloth U-shaped Dinette with Drop Down Table	S	NA	NA	S
Halo Leather U-shaped Dinette with Drop Down Table	O	NA	NA	O
Freestanding Dinette with Built-in Cabinets	NA	O	O	NA
Freestanding Dinette with Computer Workstation	NA	O	O	NA
Freestanding Dinette with Computer Workstation & One Euro Recliner	O	NA	NA	O
Home Theater Surround Sound System (Includes DVD Player)	O	O	O	O

EXTERIOR DÉCOR

FULL-BODY PAINT SCHEMES



GOLD CORAL



ROCKY MOUNTAIN BROWN



MAROON CORAL



SILVER SAND



OCEANSIDE



SUNLIT SAND

WHY BUY A TIFFIN MOTORHOME?

No one invests more time and effort into the construction and engineering of motor homes than we do at Tiffin. To ensure superior quality, we design and make many parts ourselves, such as our roof cap, one piece of moisture-resistant molded fiberglass that prevents water intrusion and seamlessly seals a 5½" layer of formed insulation. Outside wall panels are gel-coated fiberglass over high performance thermal insulation. Underfoot, the vinyl tile floor is bonded to high-impact oriented strand board, which is secured atop thermal insulation and a woven moisture barrier material. Underneath it all, every model is built on an innerframe of durable, tubular aluminum. As a new coach comes off the line, we think the result speaks for itself: There isn't a more comfortable, better-built motor home on the road today.

10-YEAR LIMITED FRAME WARRANTY

We warranty the frame of the walls, floors, and roof for 10 years.

5-YEAR LIMITED SIDEWALL BOND WARRANTY

We warranty the sidewall against delamination between the outside fiberglass and the innerframe for 5 years.

GO TO TIFFINMOTORHOMES.COM

Visit us on the web for more information on the 2013 Allegro RED and all 2013 Tiffin Motorhomes, along with the latest product and specification updates. Plus, watch videos and see other exclusive web content. You can also join us on Facebook and Twitter.

FOR PARTS & SERVICE CALL 256/356.0261



FACEBOOK.COM/TIFFINMOTORHOMES TWITTER.COM/TIFFINMOTORHOME

YOUR LOCAL TIFFIN DEALER:



Over the years, my family and I have had the pleasure of meeting many of our wonderful Tiffin customers. They're truly among the nicest folks in the world. So, if you're thinking about buying a Tiffin, don't be shy about asking our owners to tell you about their experiences. After all, no one knows our coaches better than the people who drive them. Of course, we'd love the chance to chat with you, too, so give us a call, visit our website, or just stop by the office if you're ever in Red Bay.

Safe travels!

Bob Tiffin



TIFFIN MOTORHOMES

WHEREVER YOU GO, WE GO.

105 2ND STREET NW, RED BAY, ALABAMA 35582

CALL 256/356.8661 FAX 256/356.8219